



## Features

- Available in 304 or 316L Dual-cast stainless steel construction for indoor or outdoor use
- Omni-directional Pan/Tilt has stable operation, without dithering & noises
- Integrated multi-protocol decoder controller
- GE certified aerospace materials obstruct 99% above light transmittance; Suitable for all kinds of atmospheres; with a 10 year life expectancy
- Optional Network communication / signal transmission by optical cable
- Embed in TVS surge & lightning protector to prevent pulse signal attack
- Optional quick fit interface, with hot plug function
- Electric conduction link with ALPS structure to attain 10,000,000 rpm service life
- Compatible with all the controlling devices such as DVR, matrix etc.
- Running track memory function: can memory a certain PTZ operate process within 40s, no data lost during power shortage
- Auto-reposition, Soft-address edit, Long focus speed limited, Alarm function

2MEXHP-20 Series Explosion-proof Dome Camera (Camera for short) is used in the places, where is classified as Zone1 or Zone2, contained Group II A, Group II B & Group II C gases, contained the mixture circumstance with the explosive gas atmospheres & flammable mists or dusts, where is classified as Zone21 or Zone 22. Temperature group T1~T6. Its explosion-proof quality is in accordance with EN60079-0:2009, EN60079-1:2007, EN60079-31:2009 standard.

Explosion-proof Mark: EX112G Ex d IIC T6, Ta:-40°C ≤ Ta ≤ +60°C; II2D Ex t IIIIC T80°C Db

Dome camera has integrated internal structure with compact circuit design & little heat release for operation in high temperature. Based on high integration, It achieves functions of high-speed tracking, 360° endless rotation, 180° auto flips, random scan, pattern track memory & On-Screen-Display menu etc. The Pan/Tilt adopts stable step motor driving to achieve accurate image catching & multi speed ability, suitable for monitoring large areas. As Ex high-end surveillance product, it has powerful functions, stable operation & easy installation with good cost performance.

## Specifications

CERTIFICATION PARAMETER	
<b>Manufacturers Standard</b>	EN60079-0:2009, EN60079-1:2007, EN60079-31:2009 GB3836.1-2000, GB3836.2-2000, GB12476.1-2000
<b>Configuration Mode</b>	Integrated Dome Shape
<b>Explosion-proof Mark</b>	EX112G Ex d IIC T6,Ta:-40°C≤Ta≤+60°C; II2D Ex t IIIC T80°C Db.
<b>Cable Entries</b>	1 x G3/4" Explosion-proof cable entry, Inner hole Φ15mm
MECHANICAL FEATURES	
<b>Back Box Material</b>	304 / 316L(-S) (dual-cast stainless steel)
<b>Electric Motor</b>	MAE Accurate step motor, Preset resolution 0.02°
<b>Transmission Structure</b>	Electric conduction link, High strength aluminum alloy (LY12) gear with synchronous belt
CONTROL MODEL	
<b>Communication</b>	Multi protocol (PELCO-D, PELCO-P etc.), RS485
<b>Address Range</b>	1-1024 (Soft address edit)
<b>Baud Rate</b>	2400 / 4800 / 9600 / 19200 bps
<b>OSD</b>	On / Off, English menu, Chinese characters overlapping
PAN / TILT	
<b>Preset Positions</b>	128
<b>Tour (SEQ)</b>	8 Tours (Each tour with 16 / 8 presets, preset speed and dwell time can be set)
<b>Auto Pan</b>	3 P2P tours (between 2 presets)
<b>Pan / Tilt Range</b>	Pan: 360°Continuously; tilt: -2°~ 90°(180°auto flips)
<b>Pan / Tilt Speed</b>	Pan: 0.3°~160/220/300°/s (continuous control); Tilt: 0.3°/s~60/75/90°/s; Auto Pan: 25°/s
<b>Alarm</b>	8 Alarm inputs, 2 Auxiliary outs
<b>Optical Transmitter and Receiver</b>	Yes
CAMERA	
<b>Optional Camera</b>	SONY <sup>®</sup> , HITACHI <sup>®</sup> , SAMSUNG <sup>®</sup> , LG <sup>®</sup> , CNB <sup>®</sup> , YOKO <sup>®</sup> All-in-one camera module, BOSCH <sup>®</sup>
GENERAL	
<b>Power</b>	AC230V, 50/60Hz; AC220V, 50/60Hz; AC110V, 50/60Hz; AC24V, 50/60Hz
<b>Current</b>	≤500mA
<b>Operating Temperature</b>	-40°C~60°C
<b>Humidity</b>	≤95%(+25°C)
<b>IP</b>	IP-68 (2m/2h)
<b>Dimensions</b>	492 x 361 x 258 (H x W x D) (mm)
<b>Weight</b>	26Kg

## Dimensions

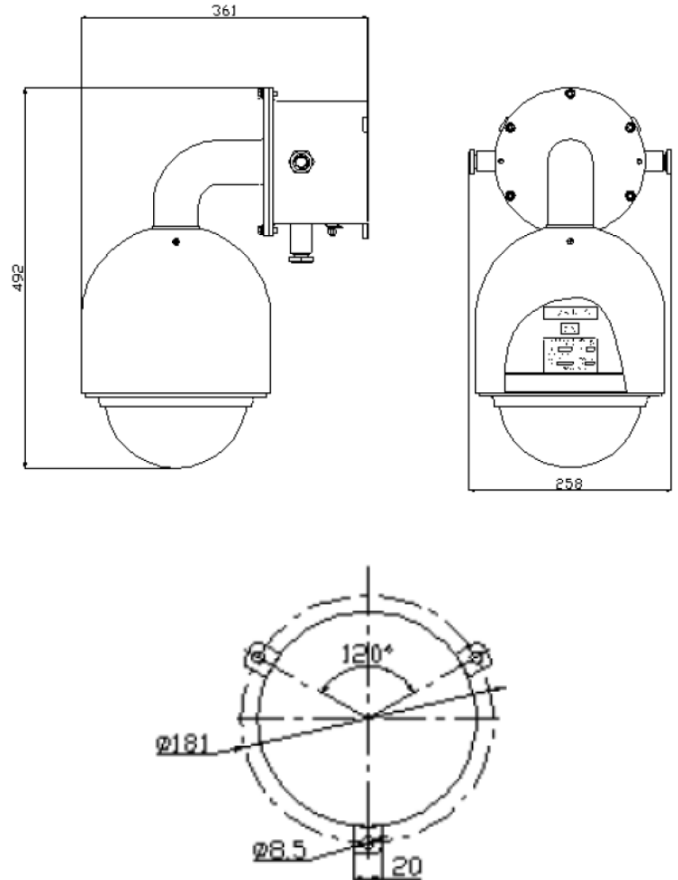

## Available Models:

MODEL	MATERIAL
<b>2MEXH-20</b>	AISI 304 Stainless Steel
<b>2MEXH-20-L</b>	AISI 316L Stainless Steel